

# BRITEZONE<sup>®</sup> LED WORK LIGHTS

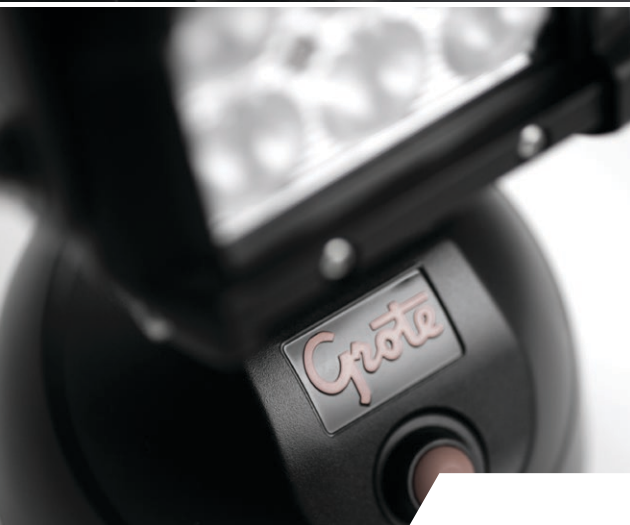

RUGGED CONSTRUCTION.  
COST EFFECTIVE.  
GROTE PERFORMANCE.



[WWW.GROTE.COM](http://WWW.GROTE.COM)



# LIGHTING YOU CAN RELY ON

Grote

## BRITEZONE® LED WORK LIGHTS, BY GROTE

Boating. Mowing. Off-roading. Whether you're working or playing, if you're out there doing your thing until long after the sun goes down—you need a lamp as tough and tireless as you are. Grote's BriteZone family has the right LED lamp for any application—from ATVs all the way to tow trucks—without breaking the bank.

### FEATURES & BENEFITS

- LED Technology
- Low Power Draw
- High Output
- Easy Installation
- Hardware Included
- Two-Year Warranty
- EMI Protection



Family owned and operated for over a century, Grote Industries is known for innovative design, quality products, and superior customer service.

Whether you need a single lamp or are outfitting an entire fleet, the Grote name promises reliability, performance, and all-weather durability.

This heritage of excellence is reflected in BriteZone®, Grote's line of affordable LED lamps that are designed to work when you need them—no excuses. Rain or shine, day or night, wet or dry—Grote's signature design, quality, and performance are on display. The rugged, durable construction and LED power of BriteZone lamps far outshine halogen. No matter the application or environment, BriteZone gets the job done.





# SQUARE & RECTANGLE



## BZ231-5

### BRITEZONE® CUBE LED WORK LAMP

- Polycarbonate Lens, Die-Cast Aluminum Housing
- Connection Type: Deutsch
- Bracket Mount
- Includes Mounting Hardware

Power: 27 Watts | 12–24 VDC  
Beam Pattern: Spot  
Brightness: 3,080 Raw Lumens  
Ingress Protection: IP67, IP69K

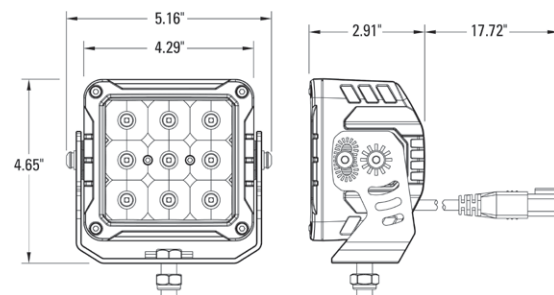

## BZ201-5

### BRITEZONE® SQUARE LED WORK LAMP

- Polycarbonate Lens, Die-Cast Aluminum Housing
- Connection Type: Blunt Cut
- Bracket Mount
- Includes Mounting Hardware

Power: 11 Watts | 9–32 VDC  
Beam Pattern: Flood  
Brightness: 1,100 Raw Lumens  
Ingress Protection: IPX7

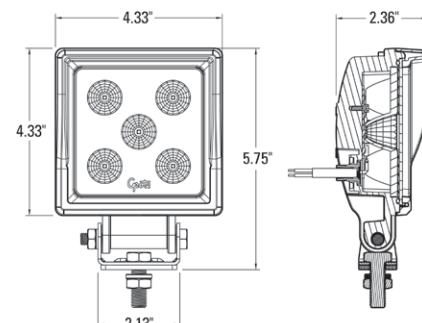

## BZ551-5

### BRITEZONE® RECTANGULAR LED WORK LAMP

- Polycarbonate Lens, Die-Cast Aluminum Housing
- Connection Type: Blunt Cut
- Bracket Mount
- Includes Mounting Hardware

Power: 15 Watts | 12–30 VDC  
Beam Pattern: Flood  
Brightness: 1,200 Raw Lumens  
Ingress Protection: IP67

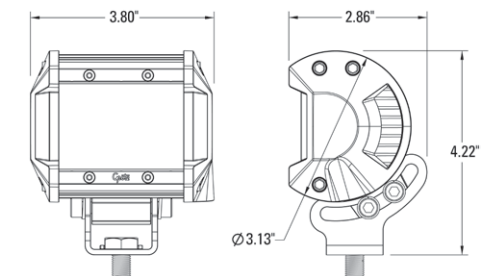

## BZ221-5

### BRITEZONE® SMALL CUBE LED WORK LAMP

- Polycarbonate Lens, Die-Cast Aluminum Housing
- Connection Type: Deutsch
- Pedestal Mount
- Includes Mounting Hardware

Power: 40.5 Watts | 10–30 VDC  
Beam Pattern: Spot  
Brightness: 4,800 Raw Lumens

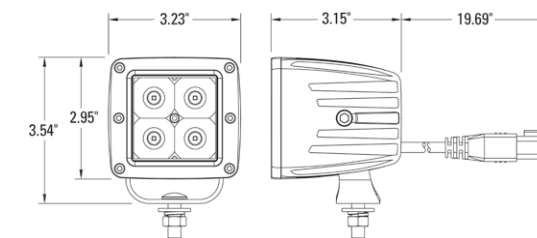

## BZ211-5

### BRITEZONE® SMALL SQUARE LED WORK LAMP

- Polycarbonate Lens, Die-Cast Aluminum Housing
- Connection Type: Blunt Cut
- Bracket Mount
- Includes Mounting Hardware

Power: 12 Watts | 10–30 VDC  
Beam Pattern: Spot  
Brightness: 1,100 Raw Lumens

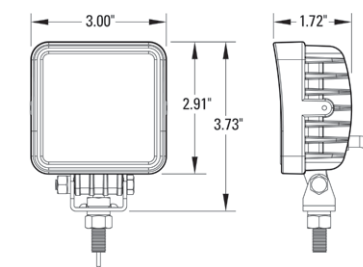



## BZ321-5

### BRITEZONE® RECESSED LED WORK LAMP

- Polycarbonate Lens, Die-Cast Aluminum Housing
- Connection Type: Blunt Cut
- Recessed Mount
- Includes Mounting Hardware

Power: **25.7 Watts** | 10–30 VDC  
Beam Pattern: **Flood**  
Brightness: **3,600 Raw Lumens**

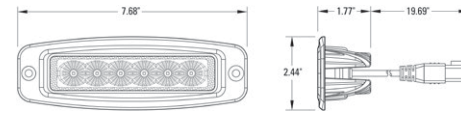

## BZ301-5

### BRITEZONE® SLIM LED WORK LAMP

- Polycarbonate Lens, Die-Cast Aluminum Housing
- Connection Type: Blunt Cut
- Bracket Mount
- Includes Mounting Hardware

Power: **16 Watts** | 9–32 VDC  
Beam Pattern: **Flood**  
Brightness: **1,400 Raw Lumens**  
Ingress Protection: **IPX7**

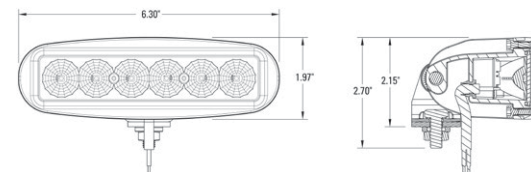

## BZ331-5

### BRITEZONE® SMALL RECTANGULAR LED WORK LAMP

- Polycarbonate Lens, Die-Cast Aluminum Housing
- Connection Type: Blunt Cut
- Bracket Mount
- Includes Mounting Hardware

Power: **9 Watts** | 10–30 VDC  
Beam Pattern: **Flood**  
Brightness: **880 Raw Lumens**

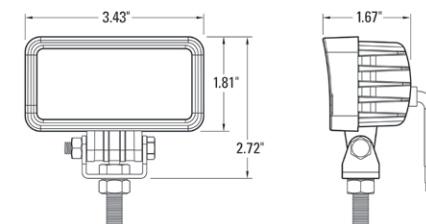

## BZ601-5

### BRITEZONE® MINI SQUARE LED WORK LAMP

- Polycarbonate Lens, Die-Cast Aluminum Housing
- Connection Type: Blunt Cut
- Bracket Mount
- Includes Mounting Hardware

Power: **8.1 Watts** | 12–36 VDC  
Beam Pattern: **Flood**  
Brightness: **775 Raw Lumens**

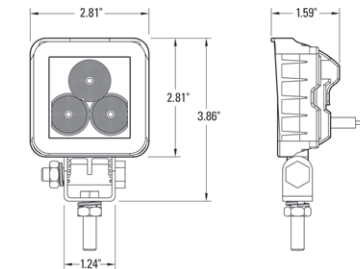

“The brightness level on this light is amazing and works well for all the dark, hard-to-see spaces under the hood.”

– Auto Mechanic and Shop Owner





# ROUND & OVAL



## BZ131-5

### BRITEZONE® SWIVEL HEAD LED WORK LAMP W/SWITCH

- Polycarbonate Lens, Die-Cast Aluminum Housing
- Connection Type: Deutsch
- Gooseneck Mount
- Includes Mounting Hardware

Power: **27 Watts** | 10–30 VDC  
Beam Pattern: **Flood**  
Brightness: **4,000 Raw Lumens**

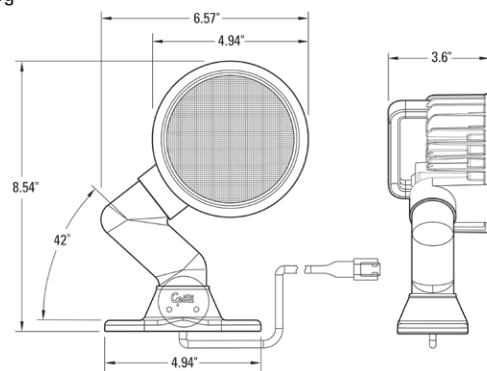

## BZ141-5

### BRITEZONE® SMALL ROUND LED WORK LAMP

- Polycarbonate Lens, Die-Cast Aluminum Housing
- Connection Type: Blunt Cut
- Bracket Mount
- Includes Mounting Hardware

Power: **18 Watts** | 10–30 VDC  
Beam Pattern: **Flood**  
Brightness: **1,750 Raw Lumens**

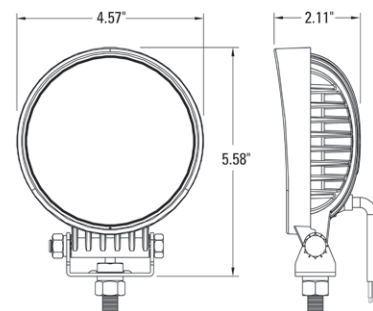

## BZ101-5

### BRITEZONE® ROUND LED WORK LAMP

- Polycarbonate Lens, Die-Cast Aluminum Housing
- Connection Type: Blunt Cut
- Bracket Mount
- Includes Mounting Hardware

Power: **16 Watts** | 9–32 VDC  
Beam Pattern: **Flood**  
Brightness: **1,600 Raw Lumens**  
Ingress Protection: **IPX7**

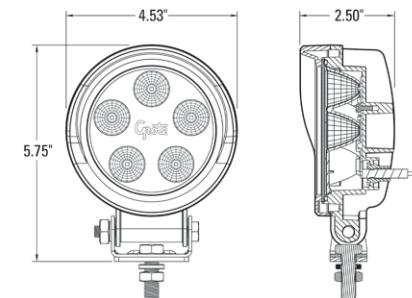

## BZ121-5

### BRITEZONE® ROUND LED WORK LAMP WITH SWITCH

- Polycarbonate Lens, Die-Cast Aluminum Housing
- Connection Type: Blunt Cut
- Bracket Mount
- Includes Mounting Hardware

Power: **24 Watts** | 10–32 VDC  
Beam Pattern: **Flood**  
Brightness: **1,920 Raw Lumens**

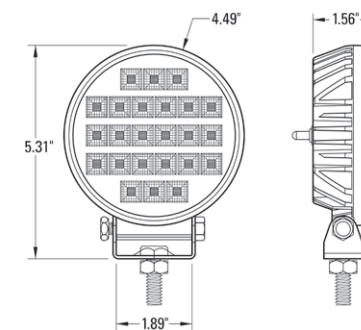

## BZ111-5

### BRITEZONE® SMALL ROUND LED WORK LAMP

- Polycarbonate Lens, Die-Cast Aluminum Housing
- Connection Type: Blunt Cut
- Bracket Mount
- Includes Mounting Hardware

Power: **14 Watts** | 12–36 VDC  
Beam Pattern: **Flood**  
Brightness: **1,240 Raw Lumens**  
Ingress Protection: **IPX7**

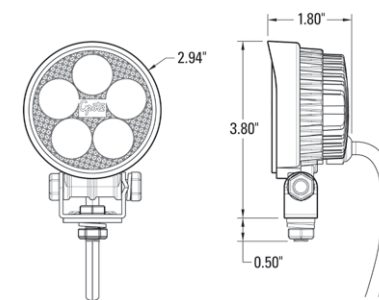



# FULL-SIZE HANDHELD



## BZ421-5

### BRITEZONE® MAGNETIC BATTERY-POWERED LED WORK LAMP

- Polycarbonate Lens, Aluminum Housing
- Includes 110 V Wall Charger & 12 V Car Charger
- The magnetic polymer base allows you to secure the lamp to most metal surfaces

Power: 12 Watts | 12 VDC  
Beam Pattern: Flood  
Brightness: 2,160 Raw Lumens

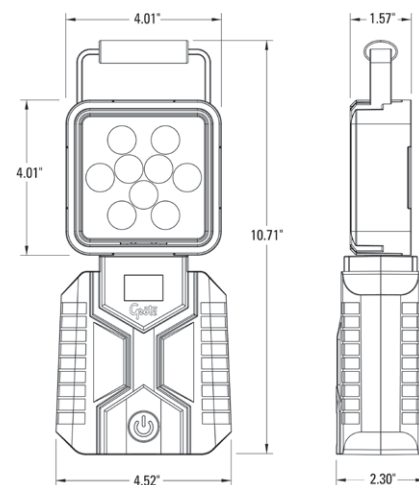

## BZ501-5

### BRITEZONE® GO ANYWHERE HANDHELD LED WORK LAMP

- Polymer Base, Polycarbonate Lens, Die-Cast Aluminum Housing
- Includes 110 V Wall Charger & 12 V Car Charger
- The magnetic polymer base allows you to secure the lamp to most metal surfaces
- 15 lbs. Magnetic Pull Force
- 5+ Hours Run Time on Full Battery Charge

Power: 12 Watts | 12 VDC  
Beam Pattern: Flood  
Brightness: 1,100 Raw Lumens

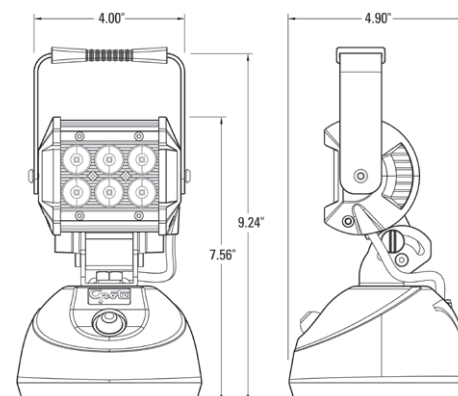

# SMALL HANDHELD

## BZ431-5

### BRITEZONE® 360° FOLDING LED POCKET LIGHT

- Rechargeable, long-lasting battery (USB-C)
- Magnetic base and 360° swivel body
- Ultra-Compact Size
- Charge Time: 2.5 Hours

Power: 3W Spot/6W Flood | 12 VDC  
Beam Pattern: Spot & Flood  
Brightness: 600/250 Raw Lumens

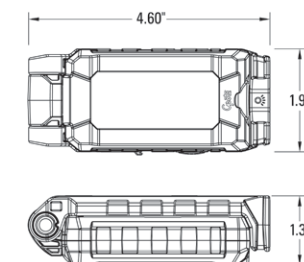

## BZ531-5

### BRITEZONE® TWINBEAM LED POCKET LIGHT

- Rechargeable, long-lasting battery (USB-C)
- Magnetic base and 180° flexible handle
- Ultra-Compact Size

Power: 3W Spot/7W Flood | 12 VDC  
Beam Pattern: Spot & Flood  
Brightness: 700/330 Raw Lumens

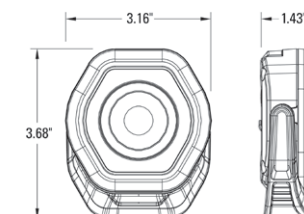





**GROTE INDUSTRIES, INC.**

2600 LANIER DRIVE  
MADISON, INDIANA 47250 USA  
T 800-628-0809  
E [safety@grote.com](mailto:safety@grote.com)

**GROTE MANUFACTURING LTD.**

230 TRAVAIL ROAD, MARKHAM,  
ONTARIO L3S 3J1 CANADA  
T 800-268-5612  
E [customerserviceca@grote.com](mailto:customerserviceca@grote.com)

**GROTE COMERCIAL LATINOAMÉRICA, S.A. DE C.V.**

AVE. GONZÁLEZ CABALLERO 225  
MONTERREY, NUEVO LEÓN 66626 MÉXICO  
T +(52) 818262 4413  
E [mexico@grote.com](mailto:mexico@grote.com)

**GROTE INDUSTRIES EUROPE GmbH**

WILLIAM-GROTE-WEG 1,  
D-94327 BOGEN, GERMANY  
T +49 9422 40331-0  
E [europe@grote.com](mailto:europe@grote.com)